



SS-210 Series

AC SOCKET



Specification:								
2.5A	250VAC	T70		2.5A 7A	250VAC 125VAC	 E196462		

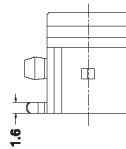
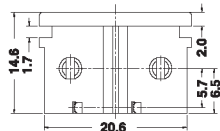
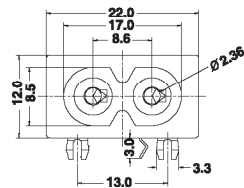

Suggested panel hole size

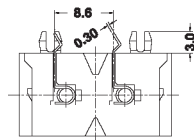
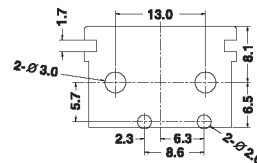

SS-210

V1		2		BK							
Sub. cat.	Terminal Type	Base Color		Internal Use Only							
SS	S	BK	Black								
SD		WT	White								
10	1	GE	Grey								
12											
20	2										
P1											
P2											
V1											
V2											